

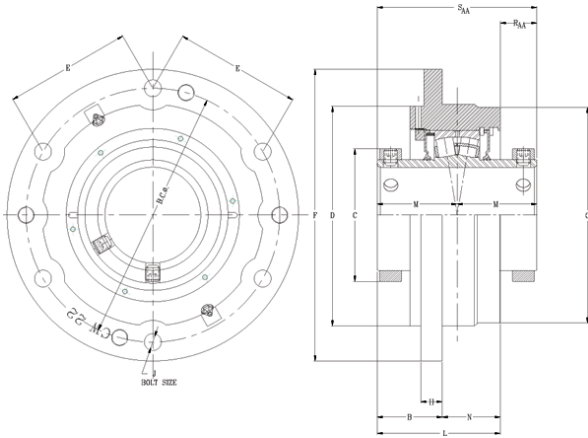

SNR BEARING CORP.OF AMERICA



timken QAACW22A115S Solid Block/Spherical Roller Bearing Housed Units-Double Concentric Piloted Flange Cartridge

Bearing No. QAACW22A115S

QAACW22A115S Bearing 2D drawings and 3D CAD models

Engineering Group	Mounted Bearing
Shaft Size	115 mm
Shaft Size Type	Metric
Full Timken Part Number	QAACW22A115SB
Locking Style	Double Concentric
Weight	72 lb
Housing Style	Piloted Flange Cartridge
UPC Code	0883450305983
Dimension BC	11.75 in
Dimension C	6.300 in
Dimension E	5.88 in
Dimension B Fix	2.44 in
Dimension B Exp	2.52 in
Dimension F	13.50 in
Dimension D	10.00 in
Dimension H	1.00 in
Dimension J (Bolt Size)	0.75 in
Dimension M	3.13 in
Dimension G	10.250 in
Dimension L Exp	5.20 in
Dimension L Fix	5.12 in
Dimension N	2.69 in
Dimension RAA	1.13 in
Dimension SAA	6.25 in
C0 - Static Load	147000 lb



SNR BEARING CORP.OF AMERICA

C - Dynamic Load (Basic)	125000 lb
e - Geometry Factor	0.25
Y1 - Geometry Factor	2.73
Y2 - Geometry Factor	4.06
Oil Lubrication - M/N Seal	900 rpm
Oil Lubrication - T Seal	1700 rpm
Oil Lubrication - B/C/O Seal	600 rpm
Grease Lubrication - M/N Seal	900 rpm
Grease Lubrication - T Seal	1200 rpm
Grease Lubrication - B/C/O Seal	600 rpm
Float	0.083 in
Shaft Tolerance	0.0050 in
Eng Internal Radial Clearance - Min	0.0030
Eng Internal Radial Clearance - Max	0.0047
Pre Install Clearance Min	0.0030 in
Pre Install Clearance Max	0.0047 in